

ASSEMBLY INSTRUCTIONS

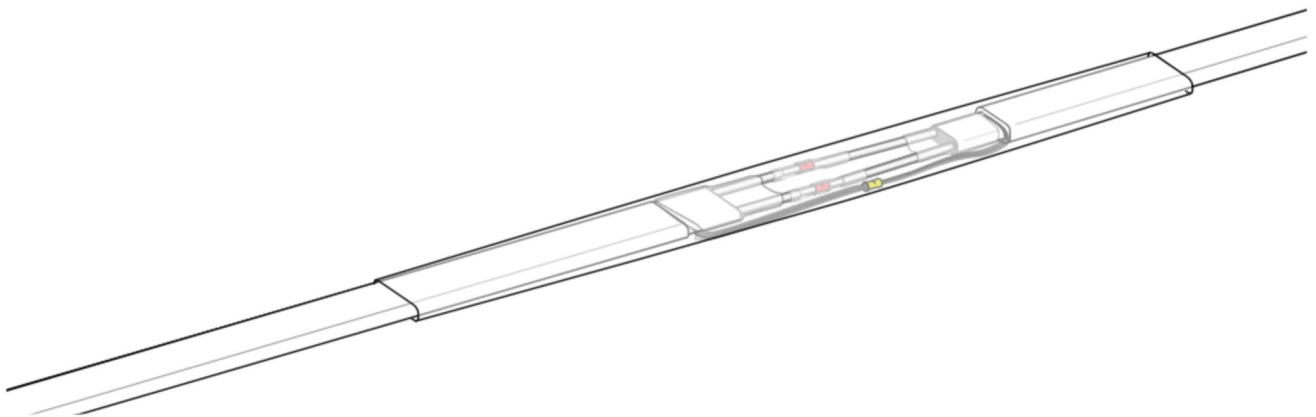

ELVB-SRV-N/-M

Connecting and repair set
for self-regulating heating cables
Types ELSR-N, ELSR-LS, ELSR-M and ELSR-R

CONTENTS

Topic	page
Recommended tools	4
Contents of connecting set	4
Option 1 Connection of heating cable - heating cable	5
Preparation	5
1.1 Remove outer jacket	5
ELSR Type BO/BOT (with braiding)	5
ELSR Type BAF (with braiding & Aluminiumfoil)	6
ELSR Type AF (with Aluminiumfoil)	6
1.2 Remove insulating cover	7
1.3 Expose supply conductors	7
1.4 Shrink the shrink tubing	7
Connection	8
Option 2 Connection of heating cable with cold cable	9
Preparation	9
Preparation heating cable	10
Preparation cold cable	10
Connection	10

IMPORTANT INFORMATION

- RETAIN FOR LATER USE



For proper and safe use of the ELVB-SRV-N and ELVB-SRV-M connection and repair sets for ELSR-N, ELSR-LS and ELSR-W as well as ELSR-M and ELSR-R self-regulating trace heaters, please follow these instructions.

Please keep these instructions for future reference (e.g. in the system documentation).

- FOR DISPOSAL



The WEEE logo indicates that this product must not be disposed of with residential waste.

Further information about disposal and recycling of old electrical and electronic devices and where to find collection points is available from your local disposal company or from the manufacturer from which you bought the product.



ATTENTION

Refers to a potentially dangerous situation.
If it is not prevented, there is a risk of damage or malfunction.



DANGER

Refers to an extremely dangerous situation.
If it is not prevented there is risk of death or at least a high risk of serious injuries.



NOTE

Important information and instructions for safe, effective and environmentally compatible usage.



WARNING

Refers to a dangerous situation.
If it is not prevented there is risk of injury or at least a high risk of material damage.

Proviso

We reserve the right to make technical changes. Changes, errors or misprints shall not form the basis for any claim to compensation for damages. Comply with the applicable and currently valid standards and regulations for safety-related components and systems.

eltherm GmbH Ernst-Heinkel-Str. 6-10 57299 Burbach P: +49 2736 4413-0 F: +49 2736 4413-50 info@eltherm.com	Document: 8643040911116		Assembly instructions ELVB-SRV-N for ELSR-N, -LS and -W ELVB-SRV-M for ELSR-M and -R	
	Author:	Peter Schmidt	Date:	20/05/2016
Revision: 08	Detlef Matthes	Date:	12/02/2024	

RECOMMENDED TOOLS

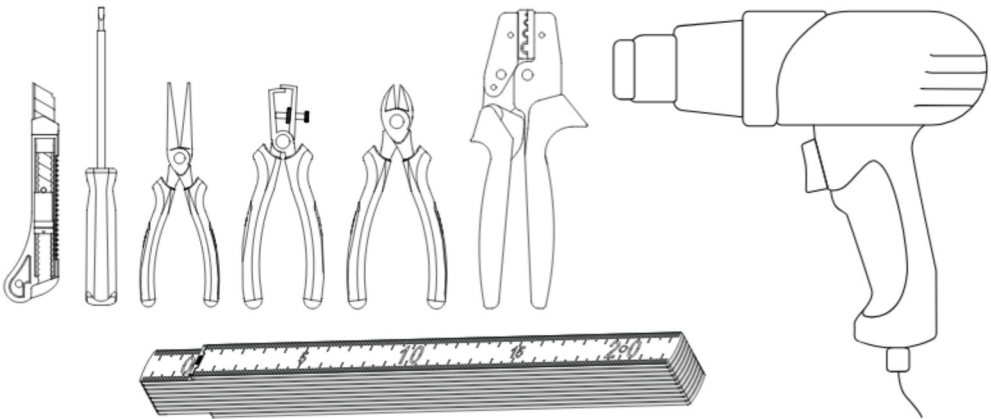

CONTENTS OF INITIAL CONNECTION AND CONNECTING SET

(ELVB-SRV-N for ELSR-N, -LS, -W, Art.No. 0911116 & ELVB-SRV-M for ELSR-M, -R, Art.No. 0911122)

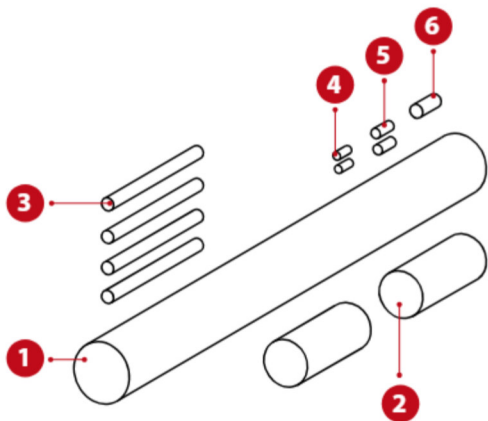

No.	Type	Quantity
1	Shrink tubing $\varnothing = 12.7 \text{ mm}$; $l = 200 \text{ mm}$; bk	1 Unit
2	Shrink tubing $\varnothing = 9.5 \text{ mm}$; $l = 30 \text{ mm}$; bk	2 Units
3	Shrink tubing $\varnothing = 3.0 \text{ mm}$; $l = 40 \text{ mm}$; bk	4 Units
4	$0.5 \text{ mm}^2/1 \text{ mm}^2$ insul. Butt connector; red	2 Units
5	$1.5 \text{ mm}^2/2.5 \text{ mm}^2$ insul. Butt connector; blue	2 Units
6a	Nickel sleeve $4.0 \times 0.4 \times 15 \text{ mm}$; bare (0911122)	1 Unit
6b	Nickel sleeve $4.8 \times 0.4 \times 9 \text{ mm}$; bare (0911116)	1 Unit

ATTENTION

- Work may only be performed by authorised and qualified specialists!
- After work is complete, check the resistance and insulation resistance!
- Use a suitable tool for crimp connector to crimp the nickel sleeves (for example Stocko WZ100 with insert E66 or similar).

WARNING

Heat the shrink tubing to about 350°C for optimum shrinking results. Avoid temperatures over 370°C : Danger of damage to the outer jacket of the heating cable! We recommend using an adjustable heat gun with baffle plate! Determine a suitable temperature setting of the heat gun by trial and error!

NOTE

This set does not include a termination. If a termination is needed, it must be ordered separately.

OPTION 1: CONNECT HEATING CABLE - HEATING CABLE

PREPARATION

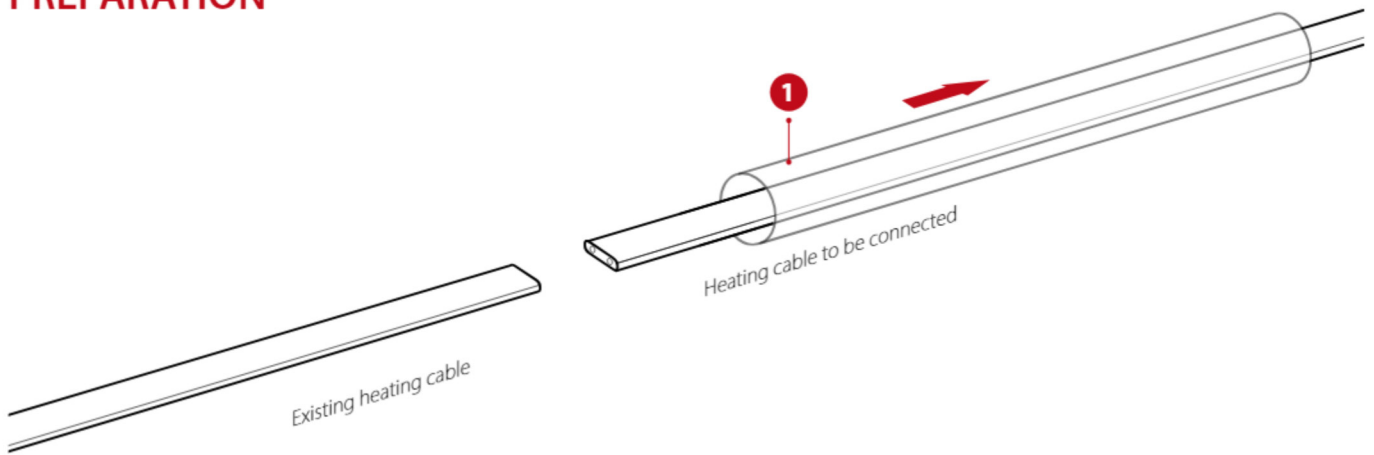

Slide on the shrink tubing (1).

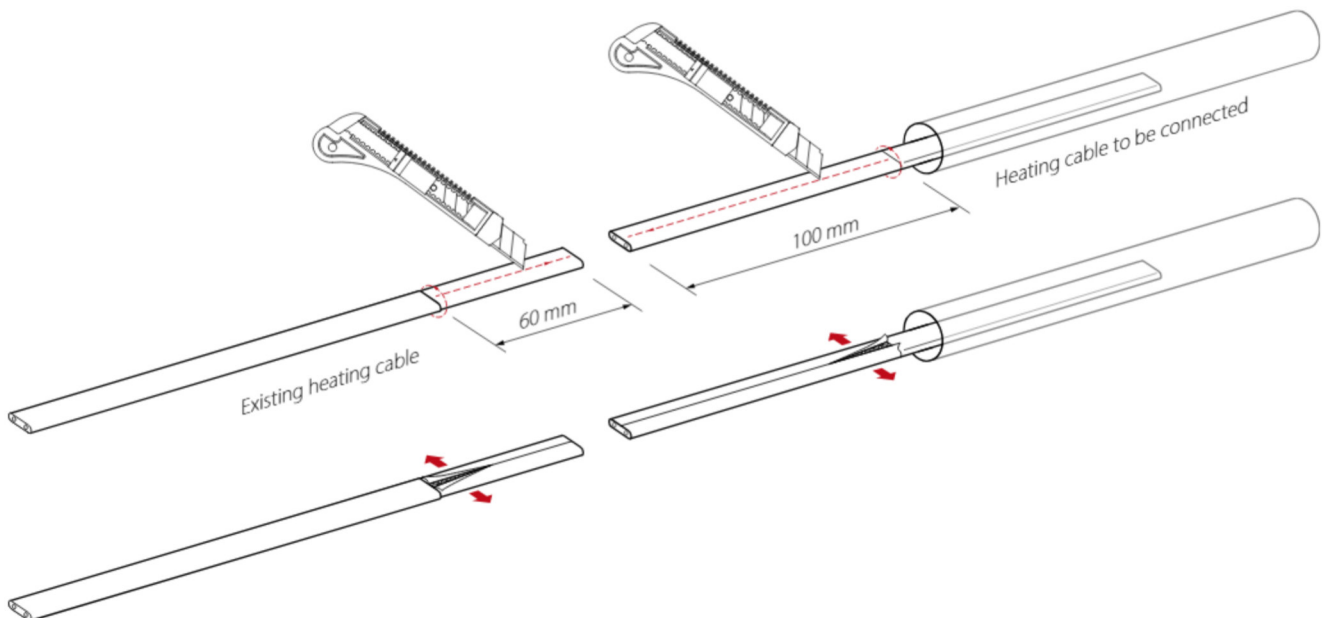

Remove the outer jacket.

1.1 Loosen protective braiding

ELSR Type BO/BOT (with braiding)

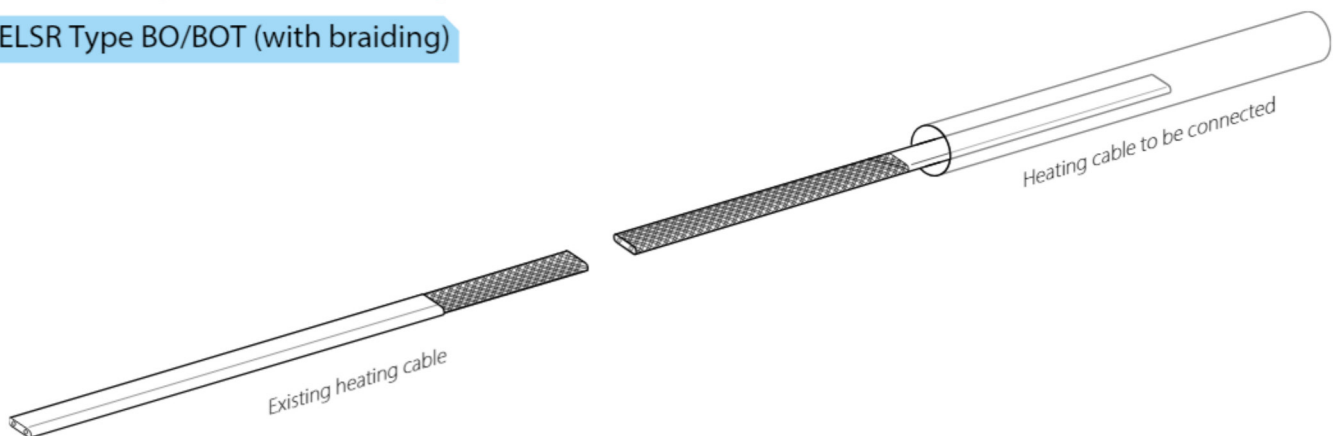

ELSR Type BAF (with braiding / Aluminiumfoil)

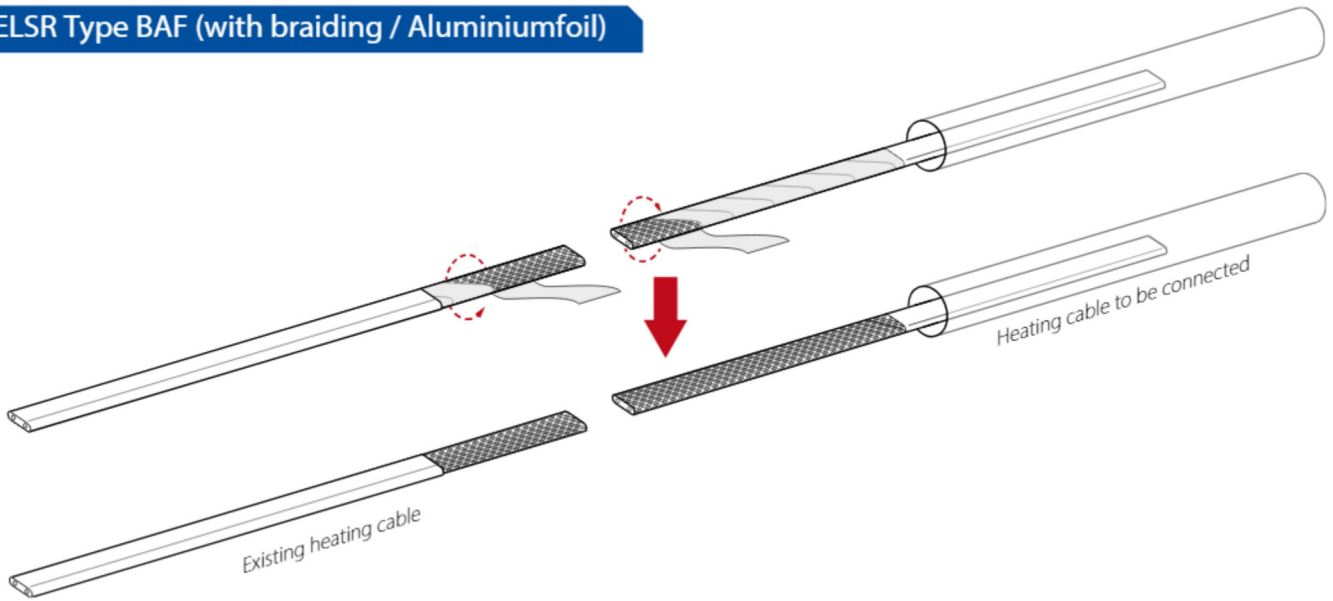

Remove the aluminium foil up to the insulation.



ELSR Type AO (with Aluminiumfoil)

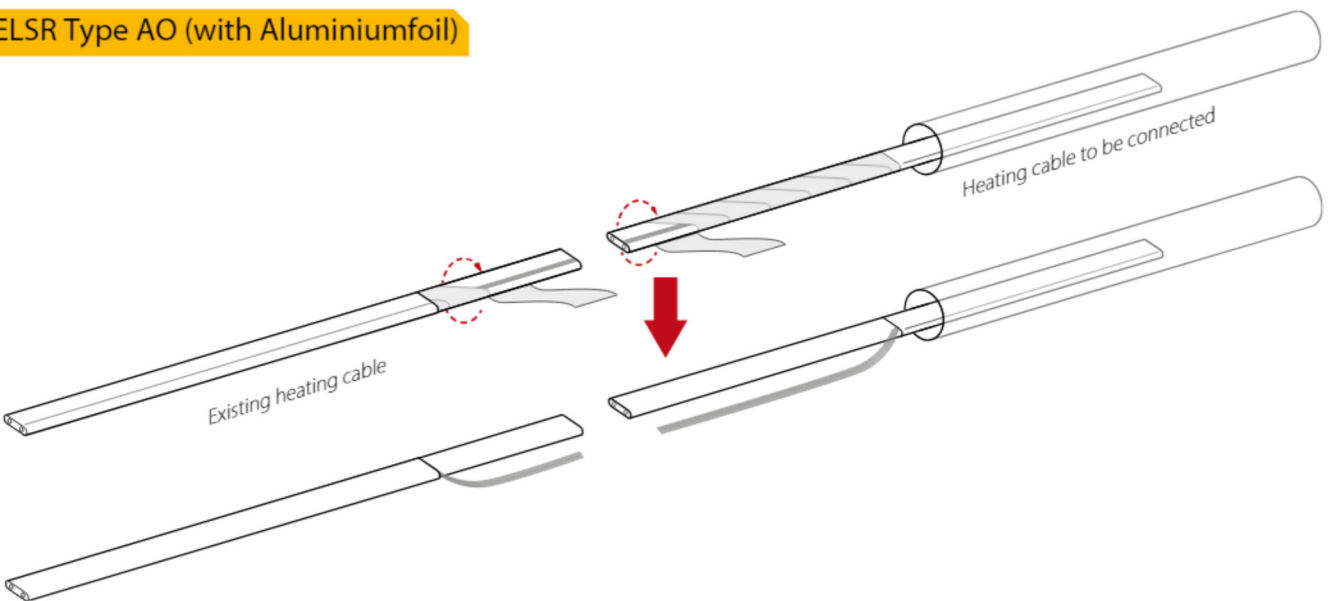

Remove the aluminium foil up to the insulation.
Bundle the protective conductor.

1.2 Remove insulating cover

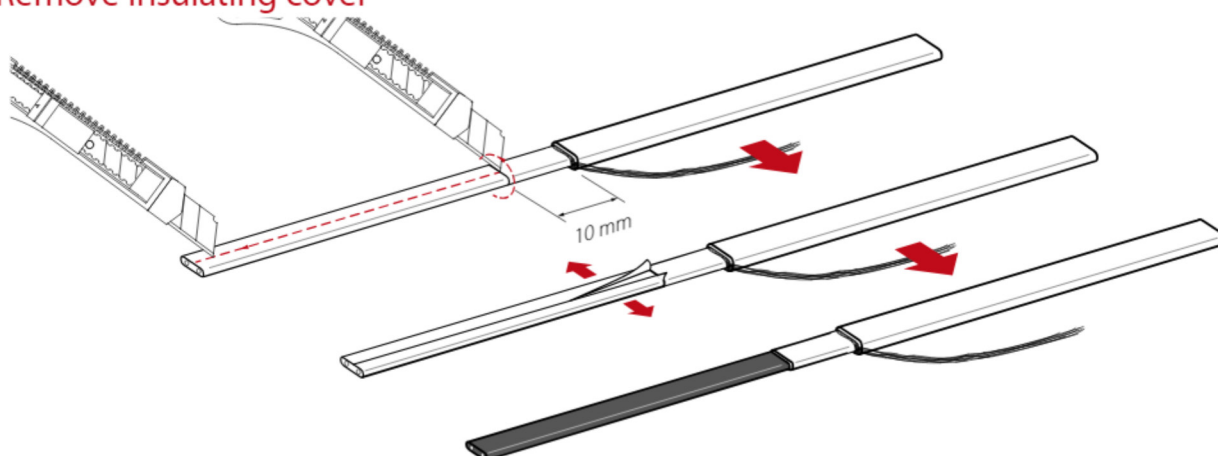

Remove the insulating sheath down to 10 mm.

1.3 Expose supply conductors

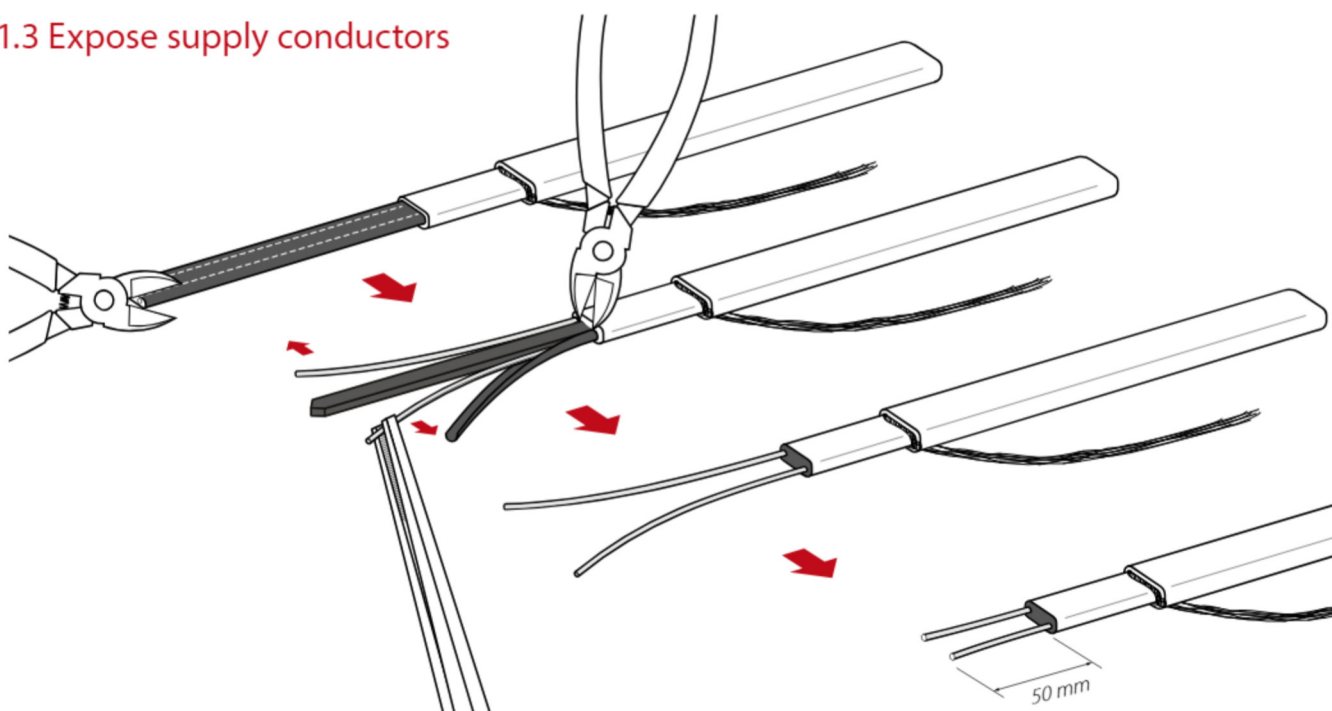

Carefully expose the supply conductors, shorten them to 50 mm and if necessary clean them!

1.4 Shrink the shrink tubing

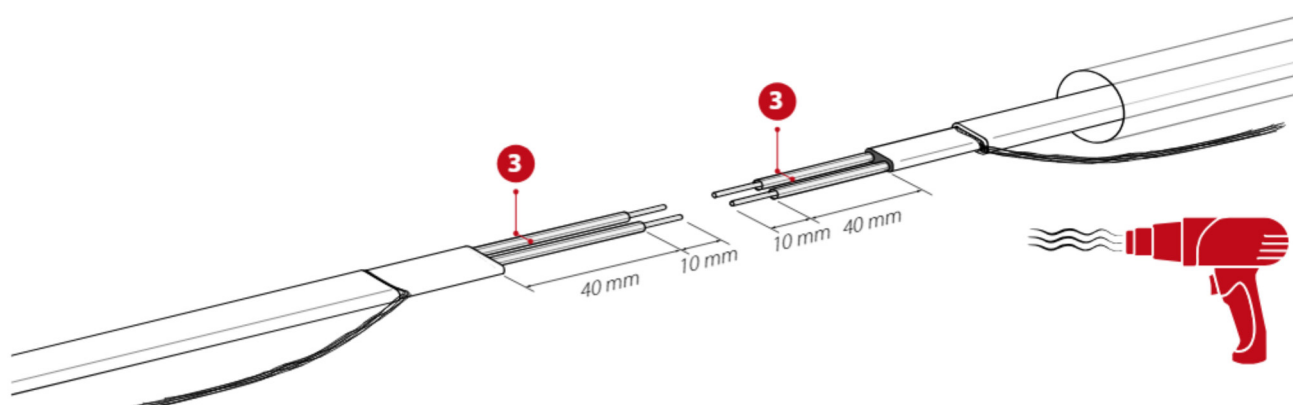

Slide on the shrink tubing (3) and shrink it.

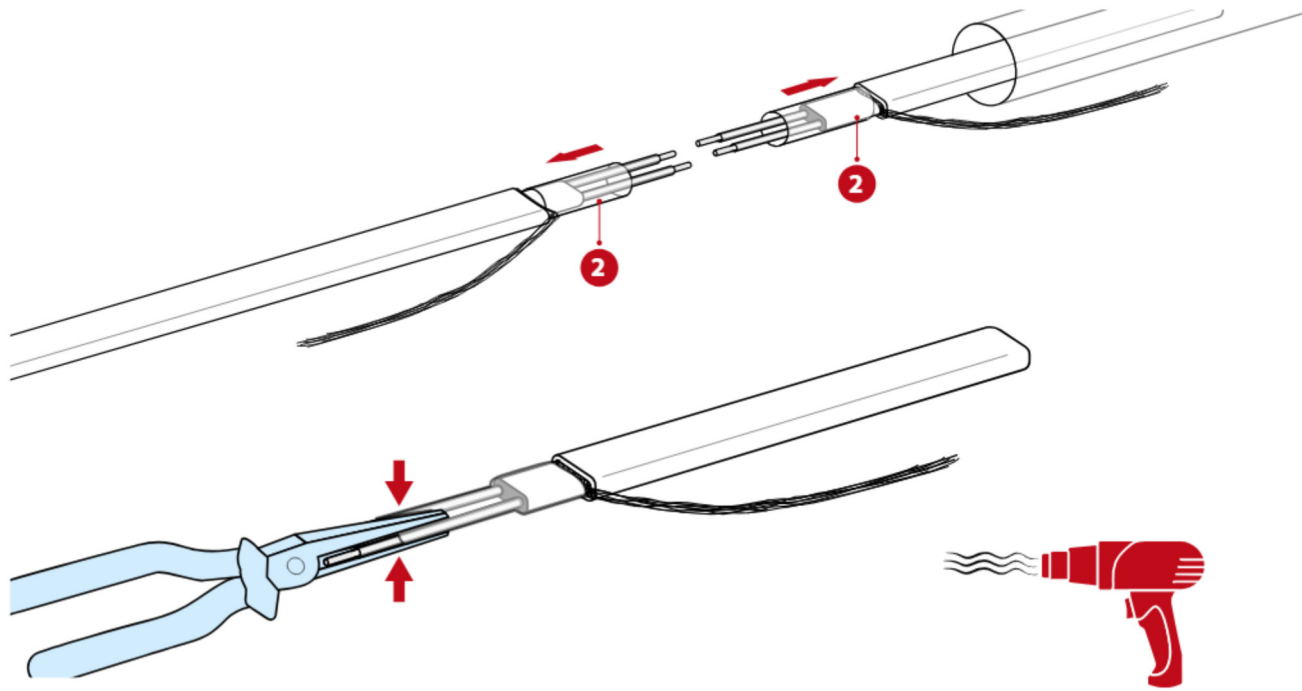

Push the heat-shrink tubing (2) up to the braiding, shrink and press together between the supply conductors with needle-nose pliers when warm.

CONNECTION

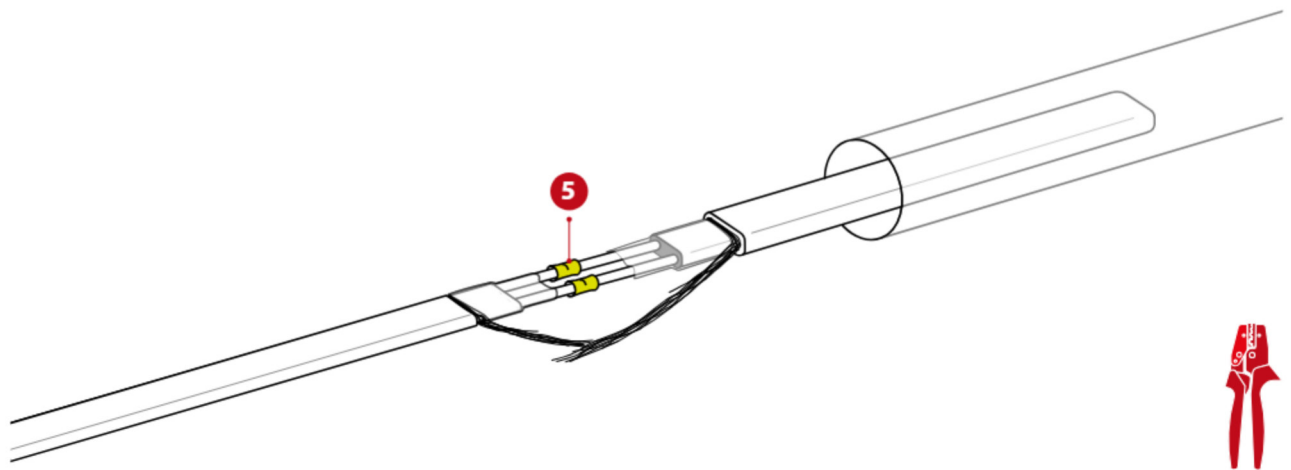

Slide the butt connector onto the supply conductors and crimp with crimping pliers.



ATTENTION

- Butt connector red only for ELSR-M & R and blue only for ELSR N, -LS & -W!
- Guide the supply conductors into the butt connector far enough so that they overlap with the wire insulation (shrink tubing)!!
- Use a suitable tool for crimp connector to crimp the nickel sleeves (for example Stocko WZ100 with insert E66 or similar).

ATTENTION

Nickel sleeve 4.0 x 0.4 x 15 mm; bare (only in art. no. 0911122)
nickel sleeve 4.8 x 0.4 x 9 mm; bare (only in art. no. 0911116)

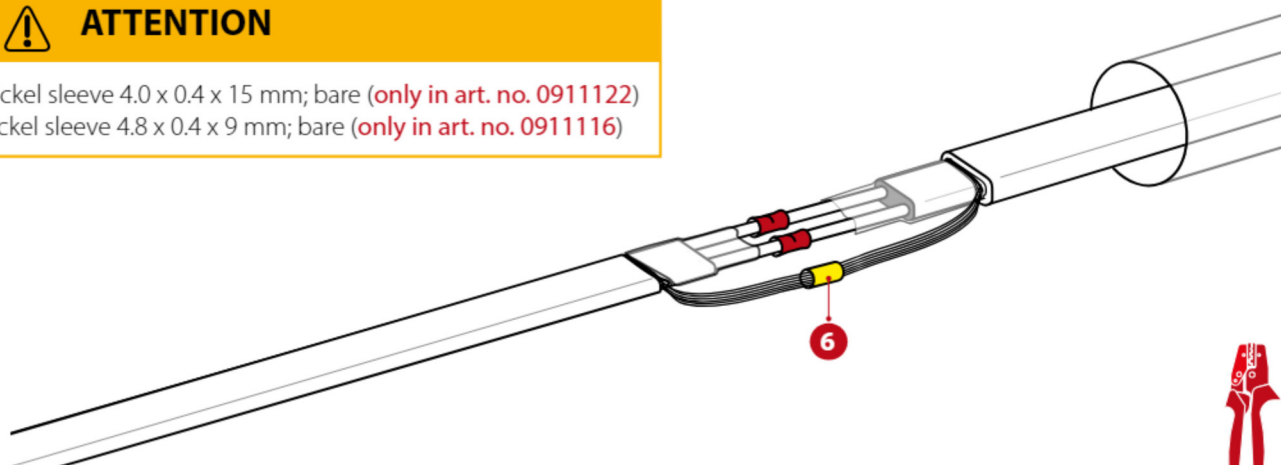

Insert the braid into the nickel sleeve (6) and crimp with crimping pliers.

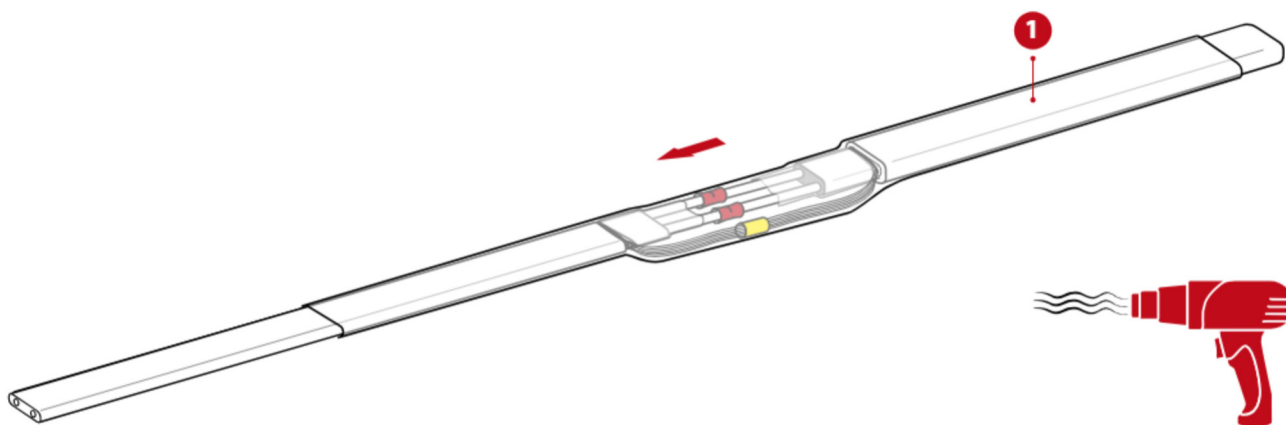

Slide the heat-shrink tubing (1) onto the centre of the connection and shrink.

OPTION 2: CONNECTION HEATING CABLE - COLD CABLE

PREPARATION

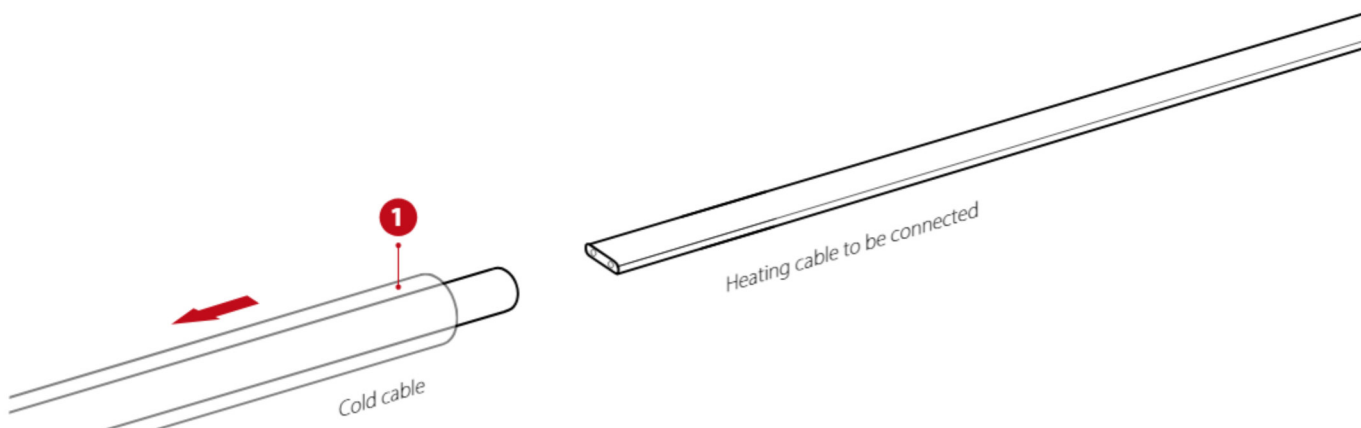

Slide on shrink tubing (1) onto the cold cable.

Preparation heating cable

Repeat the work steps on the heating cable to be connected

- 1.1 (Remove protective braiding - see page 5ff)
- 1.2 (Remove the insulating sheath - see page 7)
- 1.3 (Expose the supply conductor - see page 7)
- 1.4 (Shrink on the heat-shrink tubing - see page 7)

Preparation cold cable

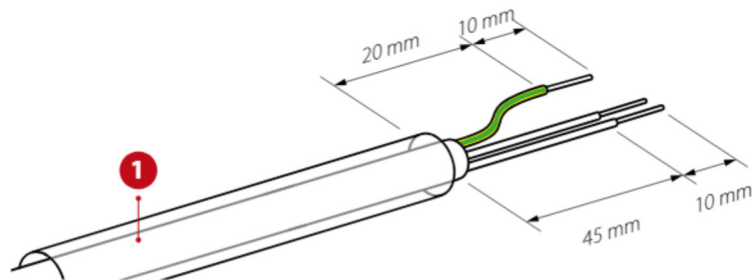

Expose all wires, shorten and remove insulation.

CONNECTION

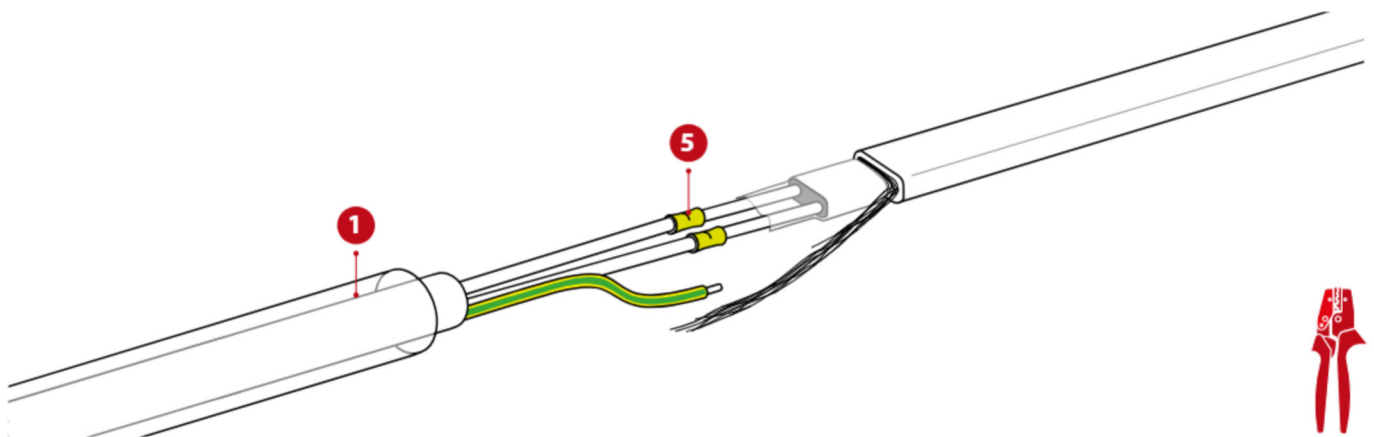

Push the butt connector (5) onto the supply conductor and crimp with crimping pliers.

ATTENTION

Nickel sleeve 4.0 x 0.4 x 15 mm; bare (only in art. no. 0911122)
nickel sleeve 4.8 x 0.4 x 9 mm; bare (only in art. no. 0911116)

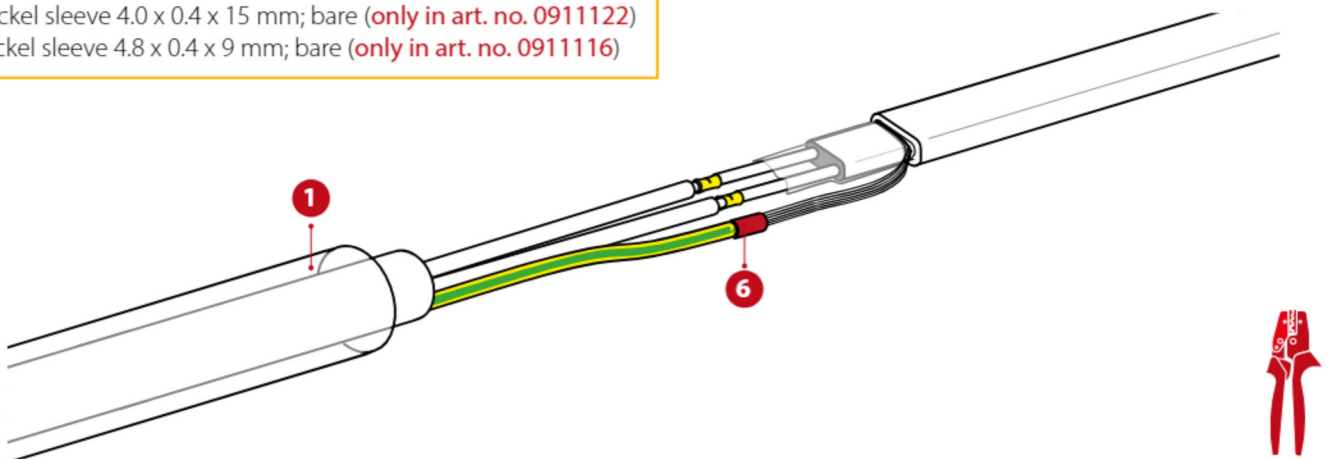

Push the heat-shrink tubing (3) onto the centre of the connection and shrink.

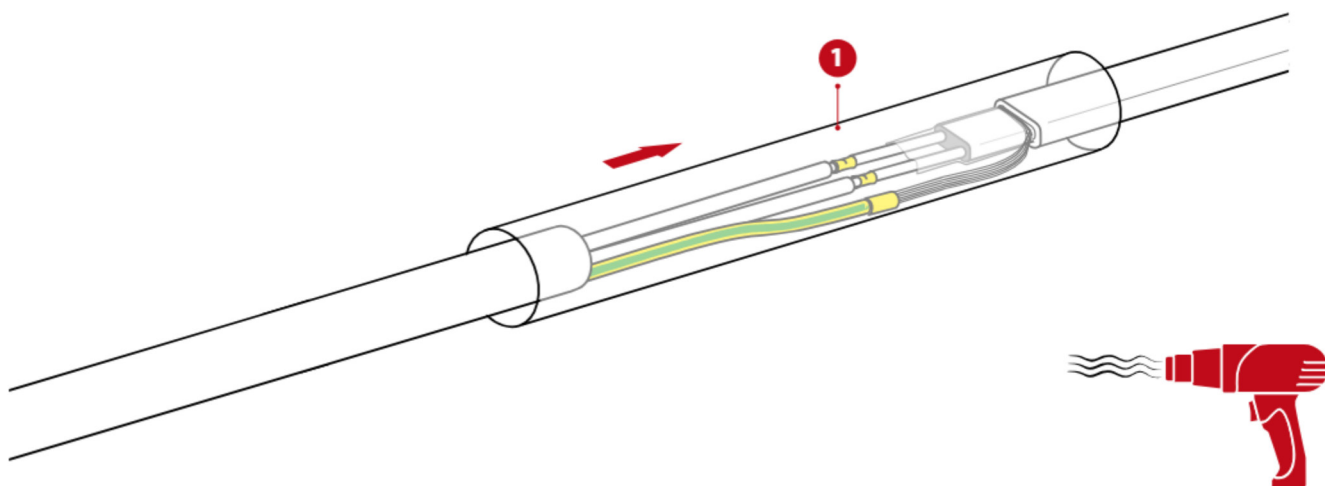

Insert braid and green/yellow into nickel sleeve (6) and crimp with crimping pliers.

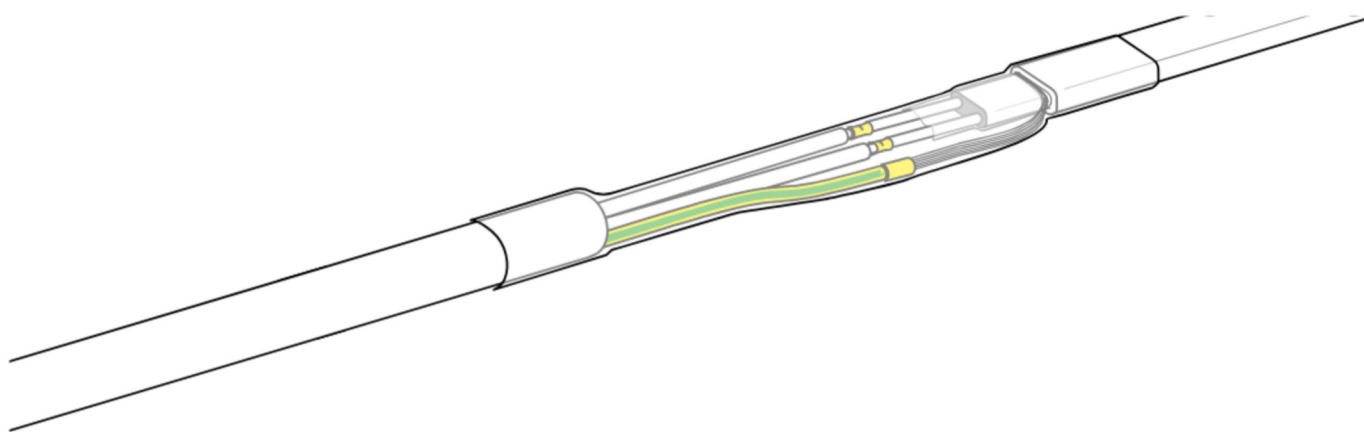

Slide the heat-shrink tubing (1) onto the centre of the connection and shrink.



This document can also be found on the eltherm website.
Visit our download area.



eltherm GmbH
Ernst-Heinkel-Straße 6-10
57299 Burbach, Germany

T.: +49 2736 4413-0
F.: +49 2736 4413-50
info@eltherm.com