

# ASSEMBLY INSTRUCTIONS

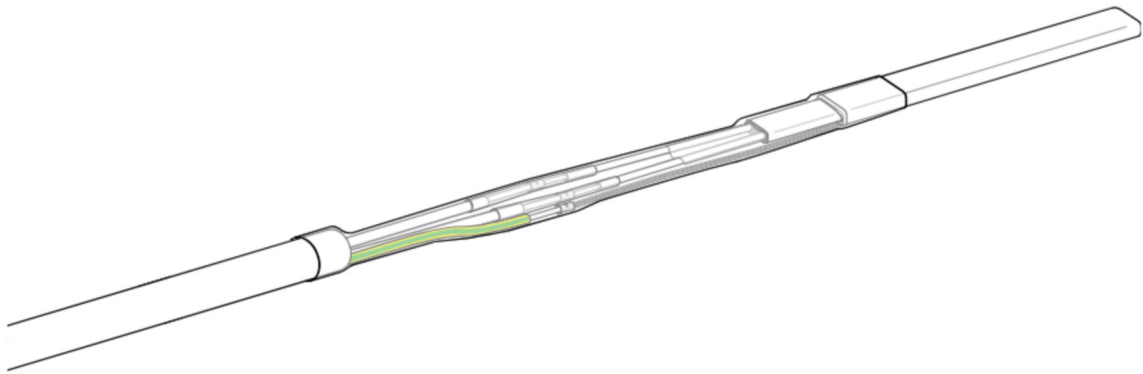

## ELVB-SRV-H

Connecting and repair set  
for self-regulating heating cables  
Types ELSR-H, ELSR-SH und ELSR-SHH

# CONTENTS

Topic	page
Recommended tools	4
Contents of initial connection and connecting set	4
<b>Option 1 Connection of heating cable - heating cable</b>	<b>5</b>
1.1 Preparation	5
1.2 Remove outer jacket	5
1.3 Loosen protective braiding	5
1.4 Remove insulating cover	6
1.5 Expose supply conductors	6
1.6 Shrink the shrink tubing	6
<b>Option 2 Connection of heating cable with cold cable</b>	<b>8</b>
2.1 Preparation of heating cable	8
2.2 Remove heating cable outer jacket	9
2.3 Heating cable - loosen protective braiding	9
2.4 Heating cable - remove insulating cover	9
2.5 Heating cable - expose supply conductors	9
2.6 Shrink heating cable shrink tubing	9
2.7 Connection cable - preparation	10
2.8 Connection of heating cable - connection cable	10
2.9 Shrink outer shrink tubing	10
<b>Notes</b>	<b>11</b>

## IMPORTANT INFORMATION

### - RETAIN FOR LATER USE



For proper and safe use of the ELVB-SRV-N and ELVB-SRV-M connection and repair sets for ELSR-H, ELSR-SH and ELSR-SHH self-regulating trace heaters, please follow these instructions. Please keep these instructions for future reference (e.g. in the system documentation).

### - FOR DISPOSAL



The WEEE logo indicates that this product must not be disposed of with residential waste.

Further information about disposal and recycling of old electrical and electronic devices and where to find collection points is available from your local disposal company or from the manufacturer from which you bought the product.



### ATTENTION

Refers to a potentially dangerous situation.  
If it is not prevented, there is a risk of damage or malfunction.



### DANGER

Refers to an extremely dangerous situation.  
If it is not prevented there is risk of death or at least a high risk of serious injuries.



### NOTE

Important information and instructions for safe, effective and environmentally compatible usage.



### WARNING

Refers to a dangerous situation.  
If it is not prevented there is risk of injury or at least a high risk of material damage.

#### Proviso

We reserve the right to make technical changes. Changes, errors or misprints shall not form the basis for any claim to compensation for damages. Comply with the applicable and currently valid standards and regulations for safety-related components and systems.

eltherm GmbH Ernst-Heinkel-Str. 6-10 57299 Burbach T.: +49 2736 4413-0 F.: +49 2736 4413-50 info@eltherm.com	Dokument: 8643040911117		Assembly instructions ELVB-SRV-H für ELSR-H, -SH und -SHH	
	Author:	Felix Kind	Date:	20.05.2016
Revision: <b>04</b>	Detlef Matthes	Date:	04.12.2023	

## RECOMMENDED TOOLS

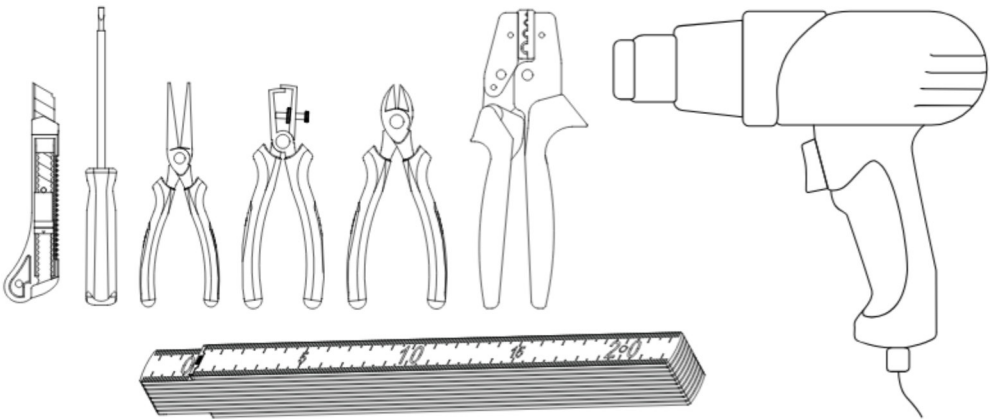

## CONTENTS OF CONNECTION SET

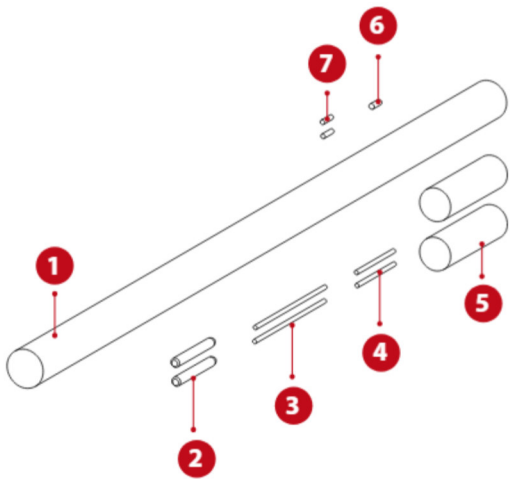

No.	Type	Quantity
1	Shrink tubing PTFE-FEP Ø = 11,4 mm; l = 200 mm; natur	1 Unit
2	Shrink tubing-Muffen PTFE-FEP Ø = 4 mm; l = 32 mm; natur	2 Units
3	Shrink tubing PTFE Ø = 3,2mm; l = 70 mm; natur	2 Units
4	Shrink tubing PTFE Ø = 3,2mm; l = 40 mm; natur	2 Units
5	Shrink tubing PTFE-FEP Ø = 8,9 mm; l = 30 mm; natur	2 Units
6	Nickel sleeve 4,8 x 0,4 x 9,0 mm; blank	1 Unit
7	Nickel sleeve 4,0 x 0,4 x 9,0 mm; blank	2 Units

### ⚠ ATTENTION

- Work may only be performed by authorised and qualified specialists!
- After work is complete, check the resistance and insulation resistance!
- Use a suitable tool for crimp connector to crimp the nickel sleeves (for example Stocko WZ100 with insert E66 or similar).

### ⚠ WARNING

Heat the shrink tubing to about 400°C up to 450°C for optimum shrinking results. Avoid temperatures over 500°C: Danger of damage to the outer jacket of the heating cable! We recommend using an adjustable heat gun with baffle plate! Determine a suitable temperature setting of the heat gun by trial and error!

### i NOTE

This set does not include a termination. If a termination is needed, it must be ordered separately.

## OPTION 1: CONNECTING SET

### 1.1 Preparation

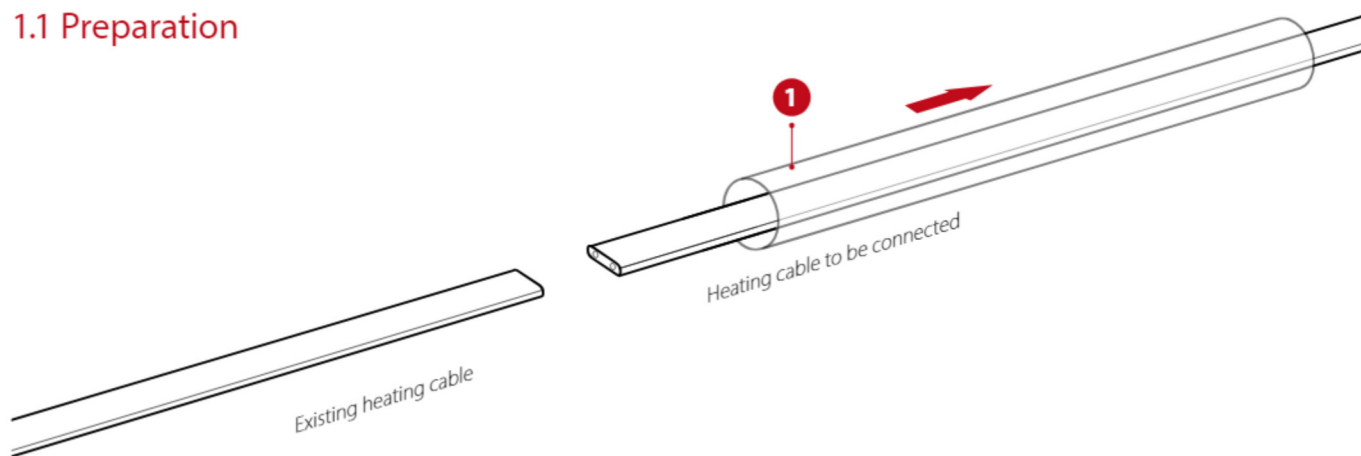

### 1.2 Remove outer jacket

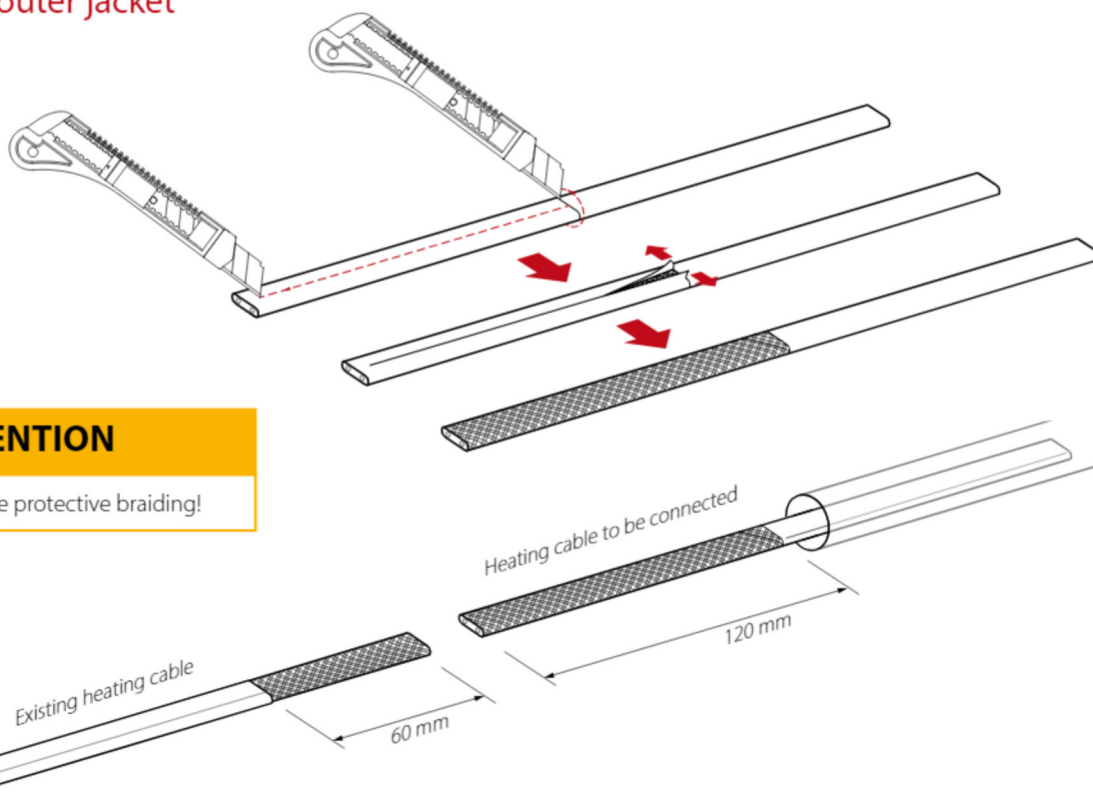

#### ATTENTION

Do not damage the protective braiding!

### 1.3 Loosen protective braiding

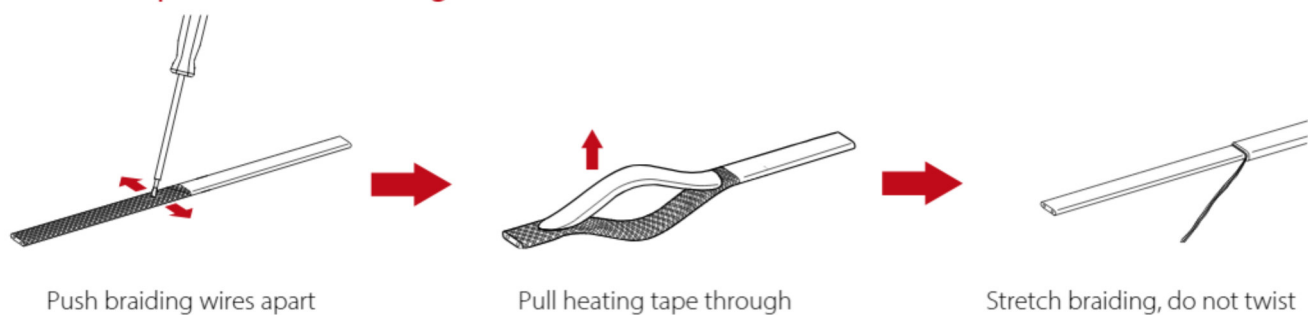

Push braiding wires apart

Pull heating tape through

Stretch braiding, do not twist

### 1.4 Remove insulating cover

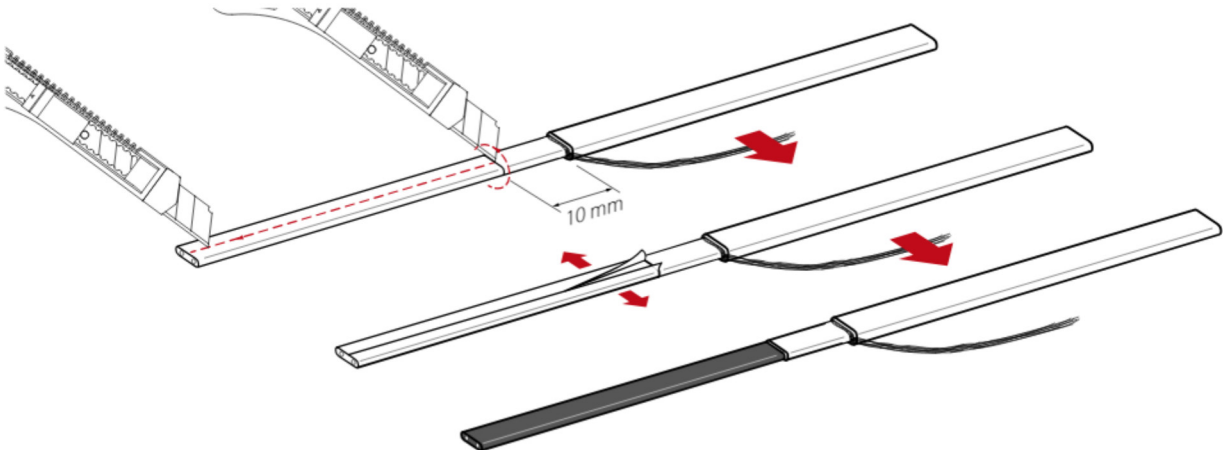

### 1.5 Expose supply conductors

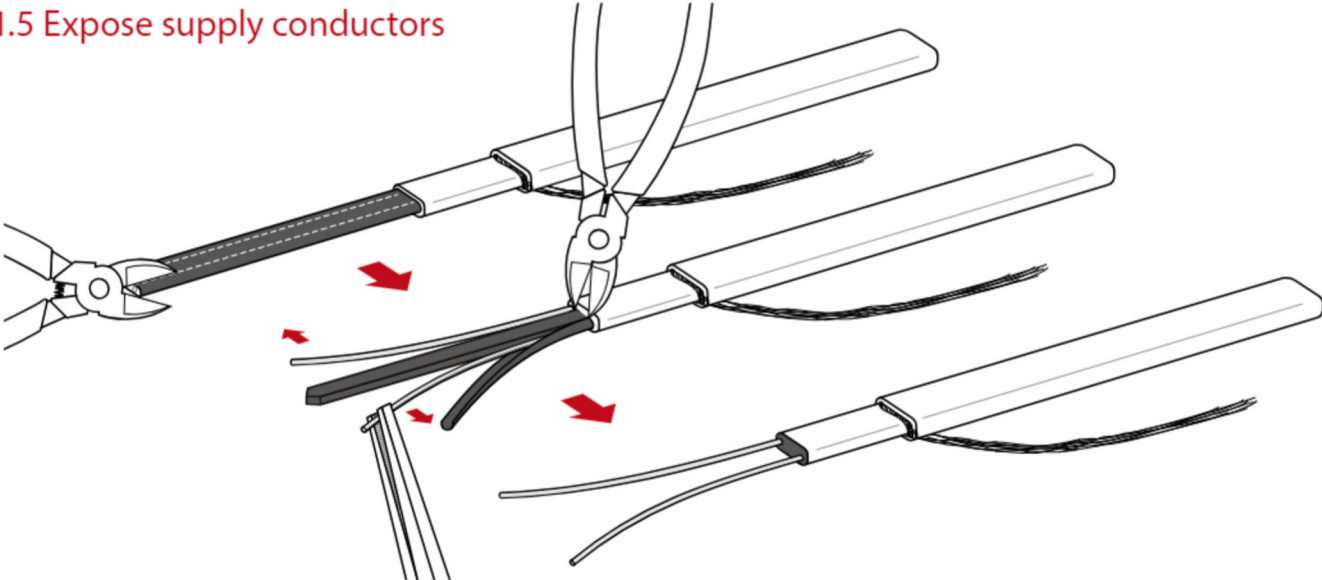

Carefully expose the supply conductors, shorten them to 80 mm, and if necessary clean them!

### 1.6 Shrink the shrink tubing

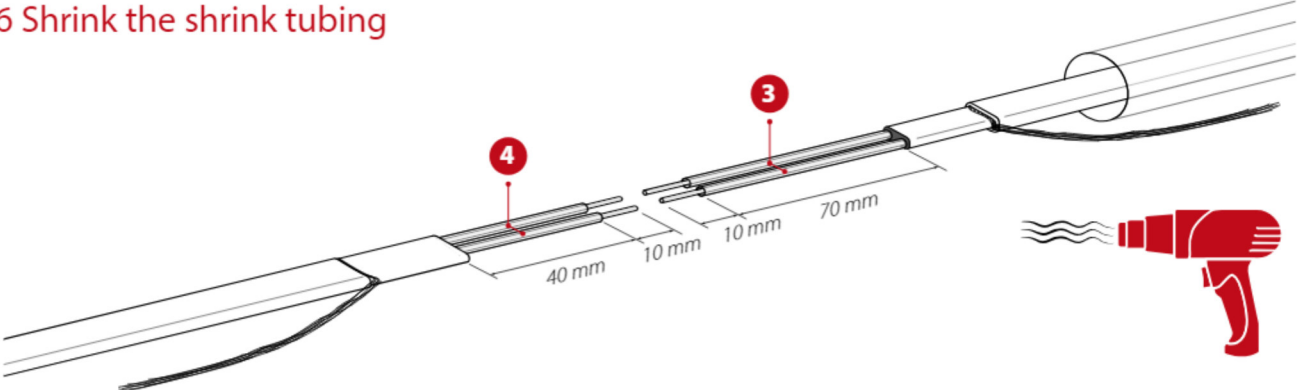

Slide on the shrink tubing and shrink it.

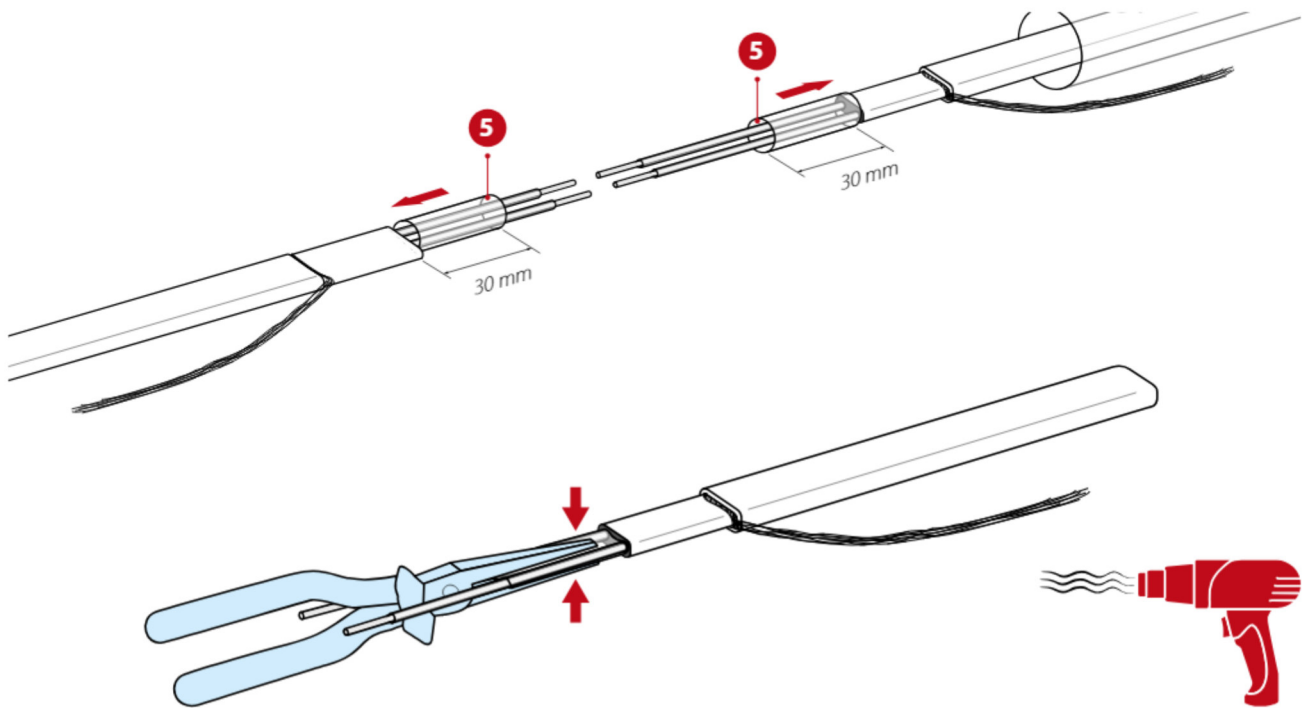

Slide on shrink tubing (5), shrink it and while it is still hot press it together between the supply conductors with long nose pliers.

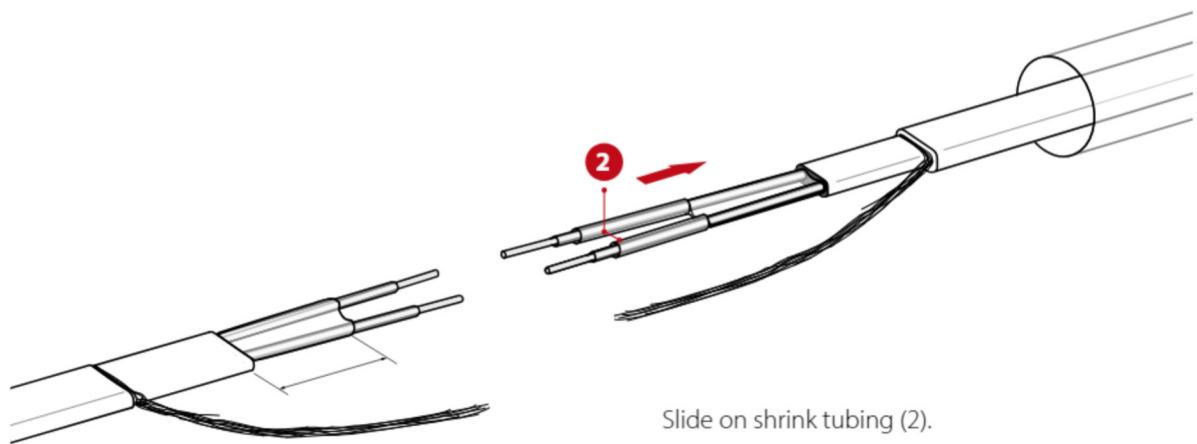

Slide on shrink tubing (2).

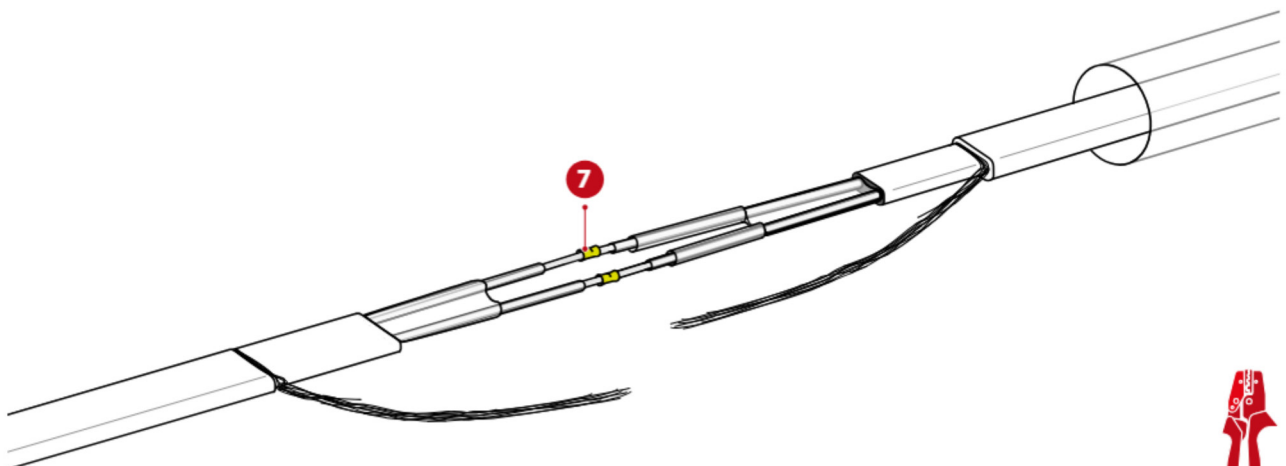

Slide the butt connector (7) onto the supply conductors and crimp with crimping pliers.

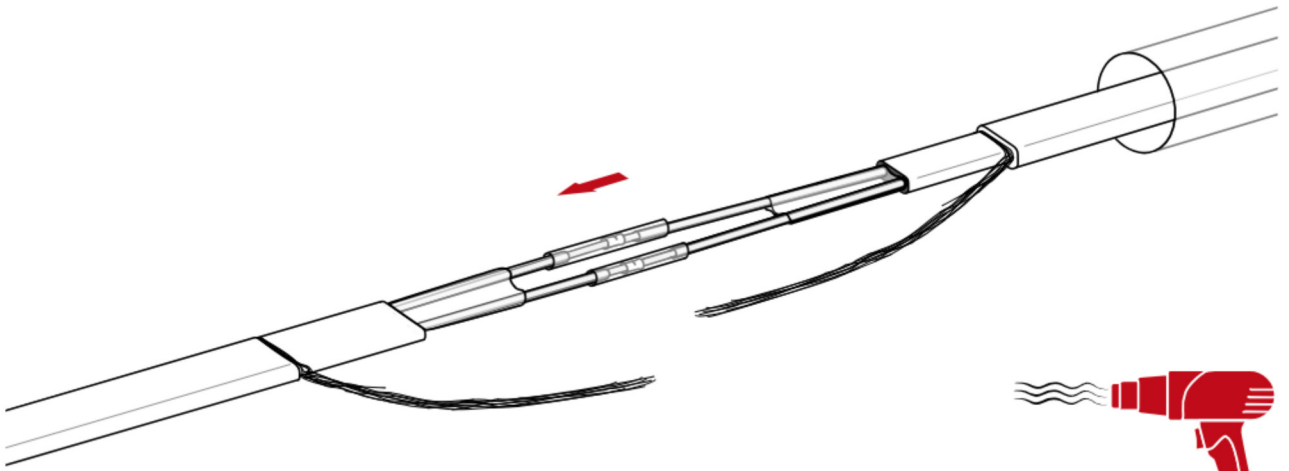

Slide the heat-shrink tubing over the centre of the crimp connection and shrink.

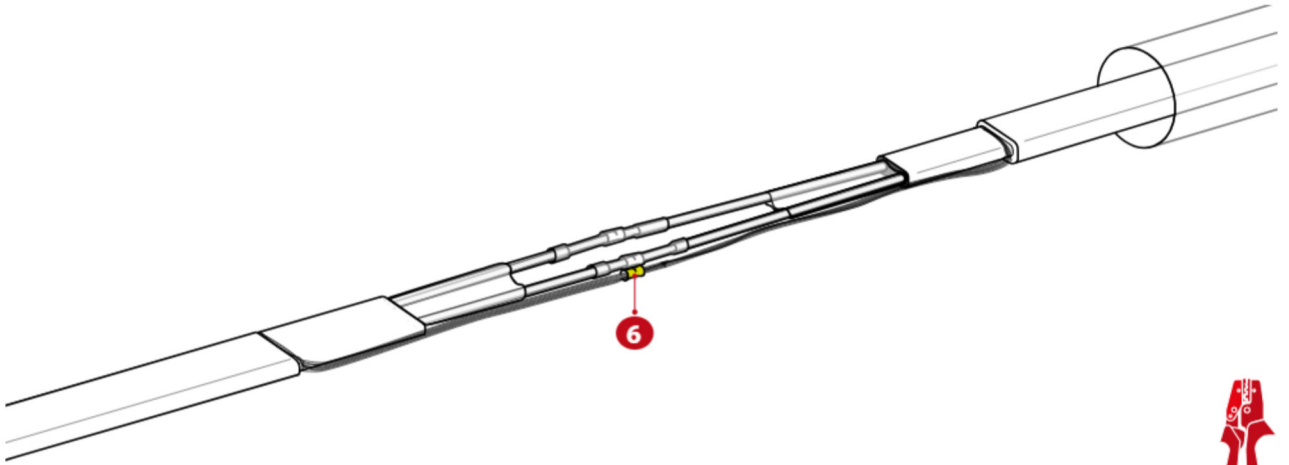

Slide the braiding into the nickel sleeve and crimp with crimping pliers.

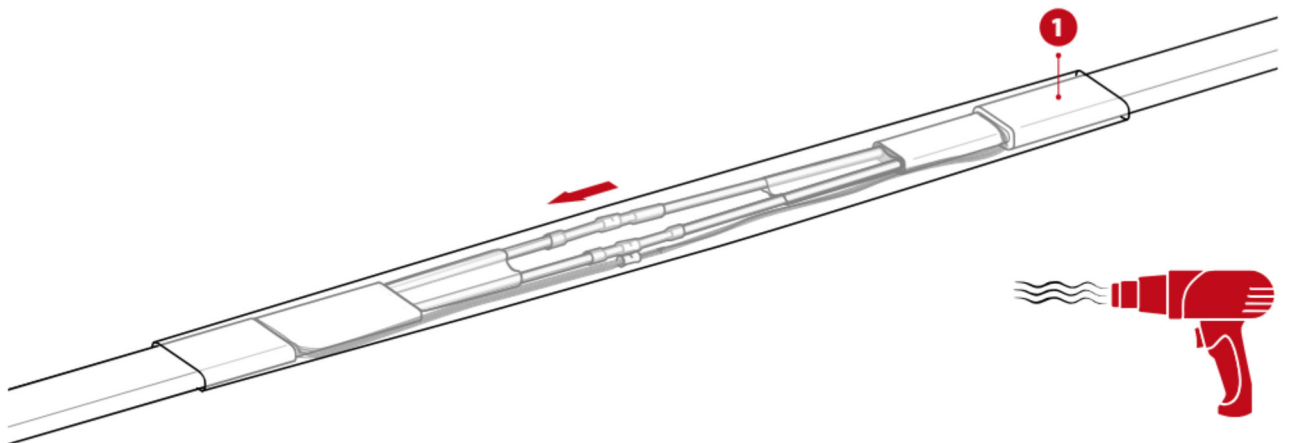

Slide on the shrink tubing (1) over the centre and shrink it.

## OPTION 2: CONNECTION OF HEATING WITH COLD CABLE

### 2.1 Preparation of heating cable

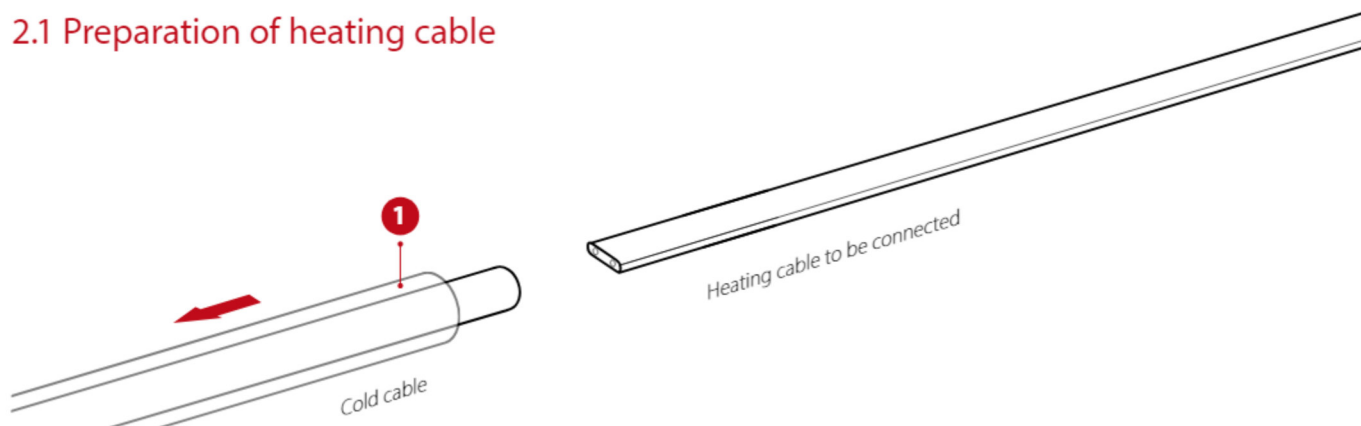

### 2.2 Heating cable - remove outer jacket

See 1.2 Remove outer jacket. ATTENTION - When connecting with cold cable, only remove 100 mm outer sheath!

### 2.3 Heating cable - loosen protective braiding

See 1.3 Loosen protective braiding.

### 2.4 Heating cable - remove insulating cover

See 1.4 Remove insulating cover.

### 2.5 Heating cable - expose supply conductors

See 1.5 Expose supply conductors.

### 2.6 Heating cable - shrink outer shrink tubing

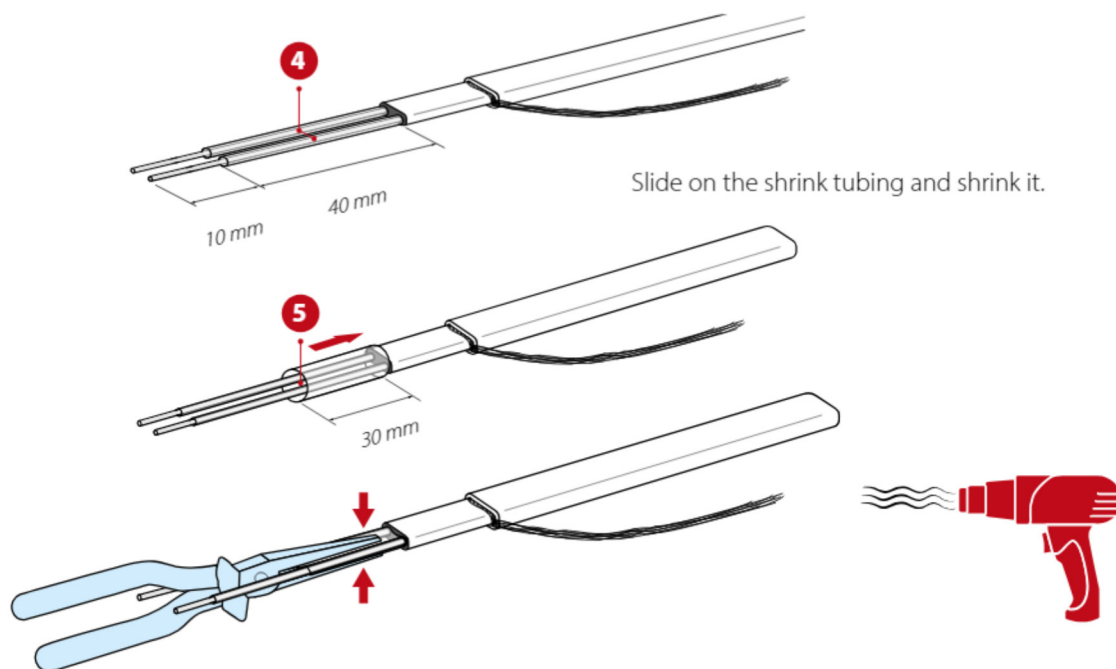

Slide on shrink tubing, shrink it and while it is still hot press it together between the supply conductors with long nose pliers.

## 2.7 Connection cable - preparation

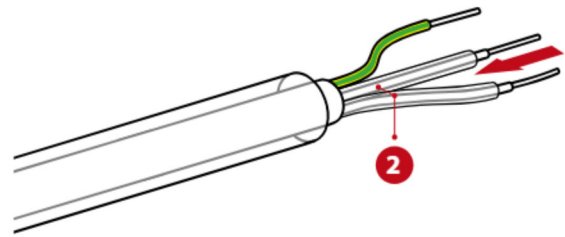
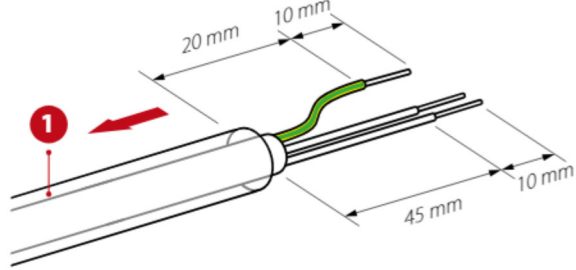

Expose individual wires, shorten and strip insulation.

## 2.8 Connection of heating cable - connection cable

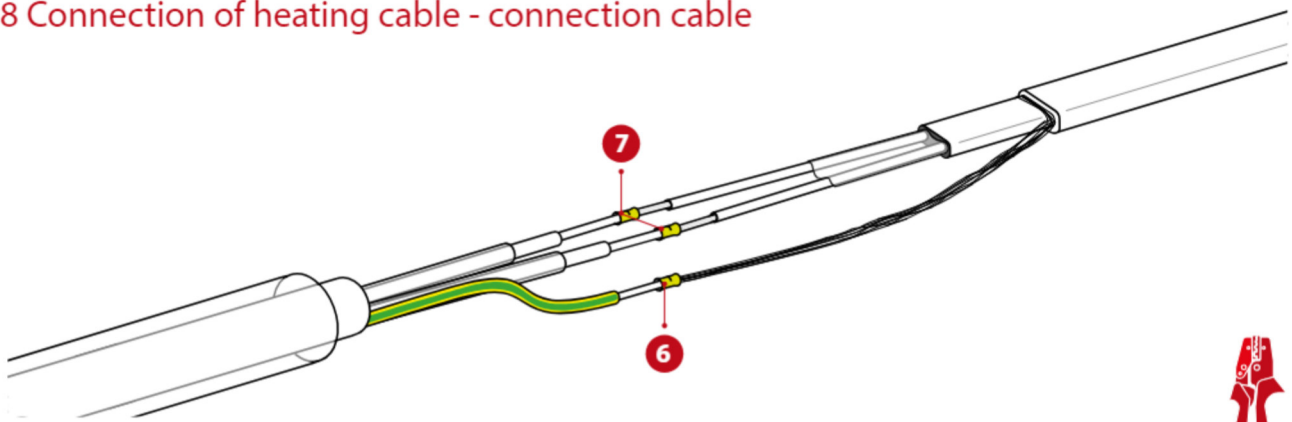

Guide the supply conductors and braiding into the corresponding nickel sleeve and crimp with crimping pliers.

## 2.9 Shrink outer shrink tubing

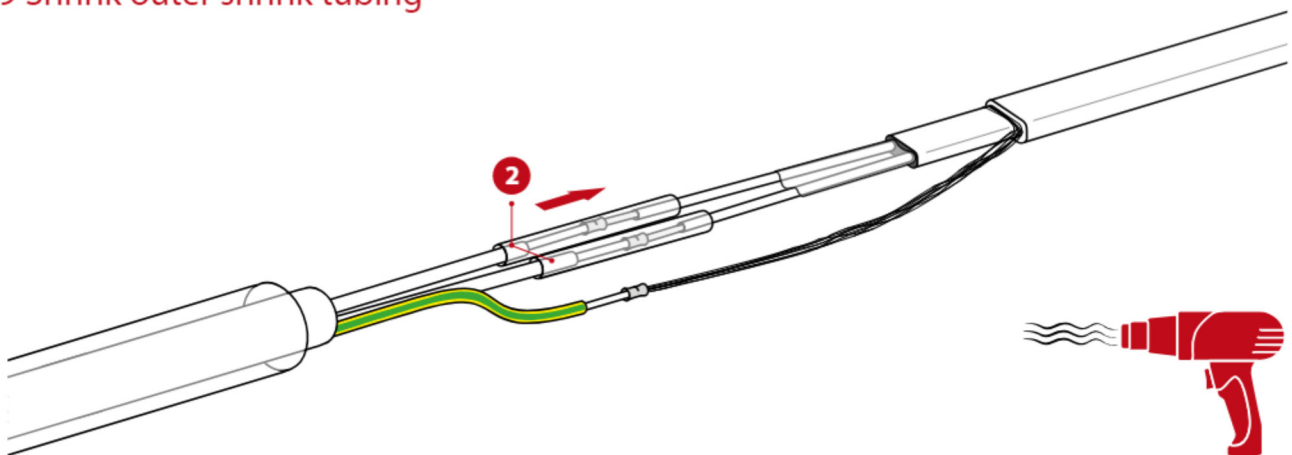

Push the heat-shrink tubing (2) onto the centre of the crimp connection and shrink.





This document can also be found on the eltherm website.  
Visit our download area.



eltherm GmbH  
Ernst-Heinkel-Straße 6-10  
57299 Burbach, Germany

T.: +49 2736 4413-0  
F.: +49 2736 4413-50  
info@eltherm.com